

Top view  
Scale: 1:1

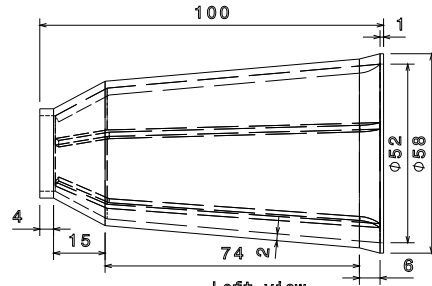

Left view  
Scale: 1:1

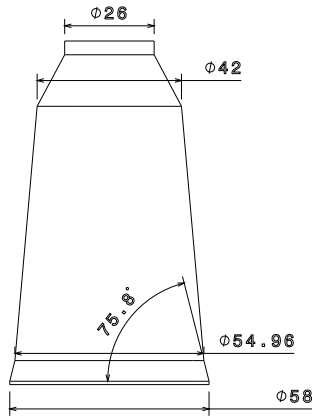

Front view  
Scale: 1:1

SL. NO.	DESCRIPTION	SPECIFICATION
01	Product	150 CC Single Cell Root Trainer (Hycopots)
02	Raw Material	HDPE
03	Colour	Black
04	Cavity Depth/ Length	100 mm
05	Cavity Volume	150 c.c.
06	Cavity Inner Diameter (Top)	52 mm
07	Outer Diameter	58 mm
08	Root Trainer Ribs	Vertical
09	No. of Ribs in each Component	05 Nos.
10	Thickness of the Ribs	2 mm
11	Rib Height	2 mm
12	Wall Thickness of the component	2 mm
13	Bottom Hole Outer Diameter	26 mm
14	Bottom Hole Inner Diameter	22 mm
15	Outer Ring	1 mm from Top
16	Tolerance	±1

### NOTE

- 1) EIGHT IMPRESSION INJECTION MOULD FOR ABOVE DRAWING
- 2) CORE & CAVITY SHOULD BE IN GOOD QUALITY (EN-24, EN-31, EN-30B, WPS, HDS, D-2, P-20 Etc.)
- 3) OTHER PART OF THE MOULD SHOULD BE IN EN-8 MATERIAL



# CIPET : CSTS

CIPET : Centre for Skilling and Technical Support (CSTS),  
Plot No.A, IDCO, Bampada Industrial Area,  
Balasore - 756056, Odisha.  
Mobile No.: +91-9937479015 / 6370703002  
Email: [apptcbls@gmail.com](mailto:apptcbls@gmail.com)/ [apptc.balasore@cipet.gov.in](mailto:apptc.balasore@cipet.gov.in)