

Top view
Scale: 1:1

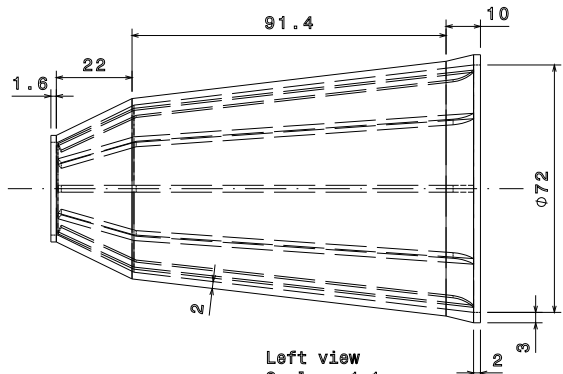

Left view
Scale: 1:1

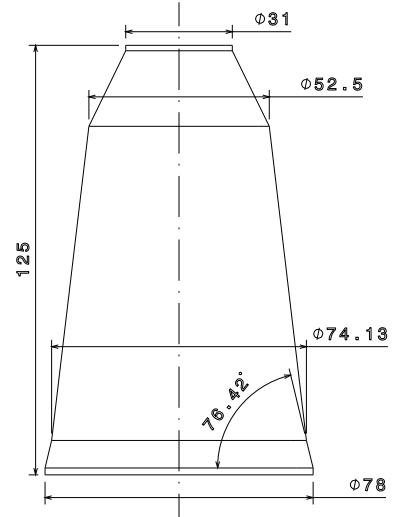

Front view
Scale: 1:1

SL. NO.	DESCRIPTION	SPECIFICATION
01	Product	300 CC Single Cell Root Trainer (Hycopot)
02	Raw Material	HDPE
03	Colour	Black
04	Cavity Depth/ Length	125 mm
05	Cavity Volume	300 c.c.
06	Cavity Inner Diameter (Top)	72 mm
07	Outer Diameter	78 mm
08	Root Trainer Ribs	Vertical
09	No. of Ribs in each Component	05 Nos.
10	Thickness of the Ribs	2 mm
11	Rib Height	2 mm
12	Wall Thickness of the component	2 mm
13	Bottom Hole Outer Diameter	31 mm
14	Bottom Hole Inner Diameter	27 mm
15	Outer Ring	2 mm from Top
16	Tolerance	±1

NOTE

- 1) FOUR IMPRESSION INJECTION MOULD FOR ABOVE DRAWING
- 2) CORE & CAVITY SHOULD BE IN GOOD QUALITY (EN-24,EN-31, EN-30B, WPS, HDS,D-2,P-20 Etc.)
- 3) OTHER PART OF THE MOULD SHOULD BE IN EN-8 MATERIAL



CIPET : CSTS

CIPET : Centre for Skilling and Technical Support (CSTS),
 Plot No.A, IDCO, Bampada Industrial Area,
 Balasore - 756056, Odisha.
 Mobile No.: +91-6370703009 / 6370703002
 Email: apptcbls@gmail.com/ apptc.balasore@cipet.gov.in